

IM B3 Dimensions (Aluminum Frame)

See page 29 for B14 & B5 flange dimensions

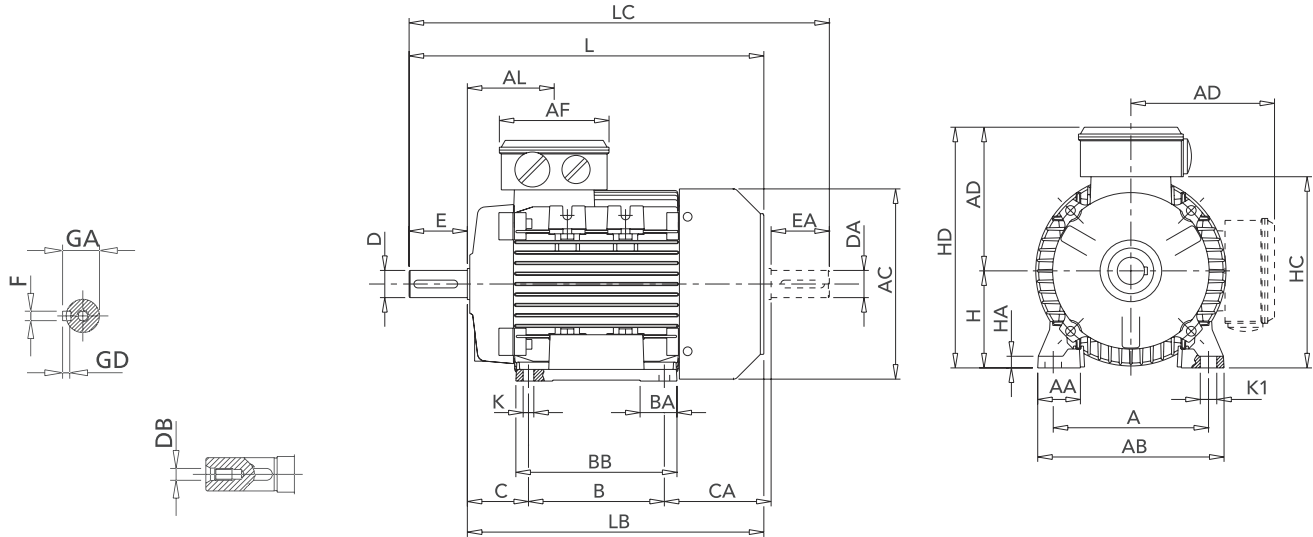

• F2 (right side) LEAD BOX IS STANDARD

NON-DRIVE END SHAFT IS OPTIONAL LC, EA, DA

IM B3 - AMPH Series
All dimensions in mm

H (Frame)	Pole	HP	A	B	C	K ¹⁾	AB	BB	AD ²⁾	HD ²⁾	AC	HC	HA	K1	AL	AF	BA	AA	D/DA	E/EA	F	GD	GA	DB ³⁾	CA	L	LB	LC
80	2-4	all	125	100	50	10	153	125	140	220	160	162	9.5	14	79	116	28.5	34.5	19	40	6	6	21.5	M6	89	272	232	319
90S	2-4	all	140	100	56	10	170	150	149	239	180	181	11	15	85	116	53	37	24	50	8	7	27	M8	116	317	267	372
90S	6	1.0	140	100	56	10	170	150	149	239	180	181	11	15	85	116	53	37	24	50	8	7	27	M8	116	317	267	372
90L	2	3.0	140	125	56	10	170	150	149	239	180	181	11	15	85	116	53	37	24	50	8	7	27	M8	91	317	267	372
90L	2	4.0	140	125	56	10	170	150	138	239	180	181	11	15	85	116	53	37	24	50	8	7	27	M8	114	340	290	395
90L	4	all	140	125	56	10	170	150	149	239	180	181	11	15	85	116	53	37	24	50	8	7	27	M8	91	317	267	372
100	2	all	160	140	63	11	192	166	156	256	196	198	12	17	100	110	38	44	28	60	8	7	31	M10	110	366	306	433
100	4-6	all	160	140	63	11	192	166	156	256	198	192	12	17	118	118	41	44	28	60	8	7	31	M10	110	366	306	433
112	2	5.5-7.5	190	140	70	12.5	220	176	172	284	225	225	15	19	116	116	46	48	28	60	8	7	31	M10	126	388	328	456
112	2	10.0	190	140	70	12.5	220	176	172	284	225	225	15	19	116	116	46	48	28	60	8	7	31	M10	148	410	350	478
112	4	all	190	140	70	12.5	220	176	172	284	225	225	15	19	116	116	46	48	28	60	8	7	31	M10	126	388	328	456
112	6	1.5	190	140	70	12.5	220	176	172	284	225	225	15	19	116	116	46	48	28	60	8	7	31	M10	126	388	328	456
112	6	2.0-2.4	190	140	70	12.5	220	176	172	284	225	225	15	19	116	116	46	48	28	60	8	7	31	M10	148	410	350	478
132S	2	7.5	216	140	89	12	256	180	194	326	248	261	17	20	133	133	45	59	38	80	10	8	41	M12	134	445	365	523
132S	2	10.0	216	140	89	12	256	180	194	326	248	261	17	20	133	133	45	59	38	80	10	8	41	M12	154	465	385	543
132S	4	7.5	216	140	89	12	256	180	194	326	248	261	17	20	133	133	45	59	38	80	10	8	41	M12	174	485	405	563
132S	6	3.0-4.0	216	140	89	12	256	180	194	326	248	261	17	20	133	133	45	59	38	80	10	8	41	M12	154	465	385	543
132M	2	12.4-15.0	216	178	89	12	256	218	194	326	248	261	17	20	133	133	45	59	38	80	10	8	41	M12	156	505	425	583
132M	2	20.0	216	178	89	12	256	218	194	326	248	261	17	20	133	133	45	59	38	80	10	8	41	M12	207	556	476	640
132M	4	10.0	216	178	89	12	256	218	194	326	248	261	17	20	133	133	45	59	38	80	10	8	41	M12	156	505	425	583
132M	4	12.4	216	178	89	12	256	218	194	326	248	261	17	20	133	133	45	59	38	80	10	8	41	M12	207	556	476	640
132M	6	5.5	216	178	89	12	256	218	194	326	248	261	17	20	133	133	45	59	38	80	10	8	41	M12	136	485	405	563
160M	2-6	all	254	210	108	14	320	270	238	398	317	316	23	18	150	150	65	76	42/28	110/60	12/8	8/7	45	M16	180	608	498	668
160L	2-6	all	254	254	108	14	320	310	238	398	317	316	23	18	150	150	65	76	42/28	110/60	12/8	8/7	45	M16	180	652	542	712

1) Clearance hole for screw 2) Maximum dimension 3) Centering holes in shaft extensions to DIN 332 part 2

IM B14 / IM B5 - Flange Dimensions

See page 25-28 for motor dimensions

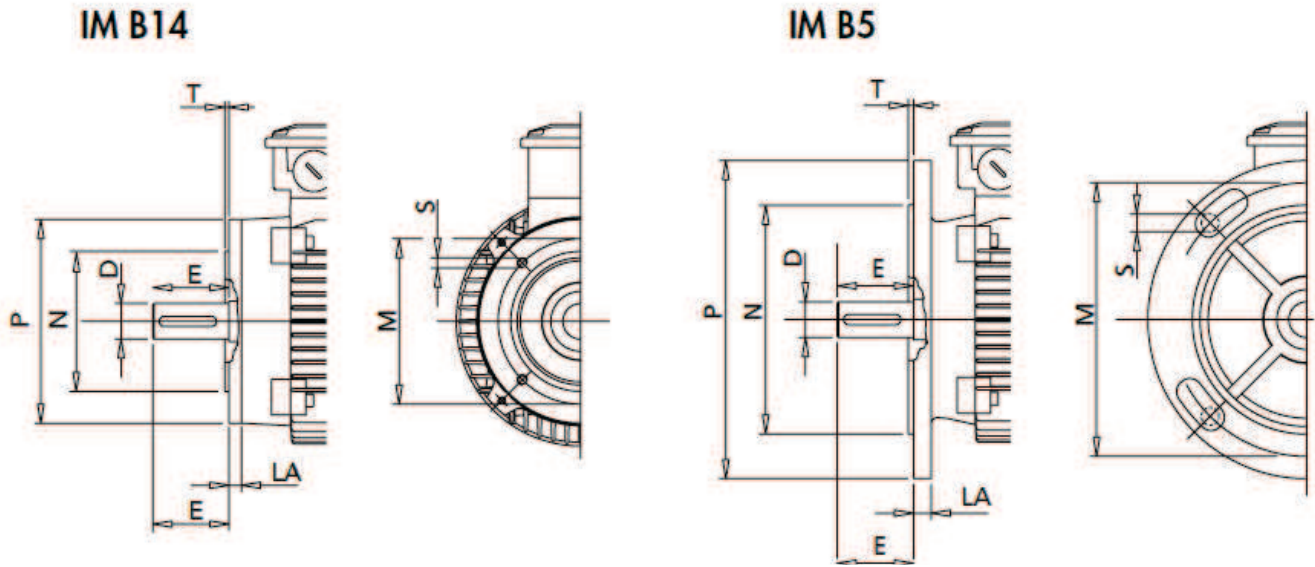

M = Center to center bolt hole circle
N = Spigot diameter
P = Outside diameter

IM B14 - C Flange & IM B5 - D Flange
All dimensions in mm

Frame	B14						B14	B14	B5						B5	B5
	M	N	P	S	T	LA	Reduced Frame	Increased Frame	M	N	P	S	T	LA	Reduced Frame	Increased Frame
56	65	50	80	M5	2.5	8	-	63	100	80	120	7	2.5	7	-	-
63	75	60	90	M5	2.5	8	56	71/80	115	95	140	9.5	3	8	56	71
71	85	70	105	M6	2.5	8	63	80/90	130	110	160	9.5	3.5	10	63/56*	80/90
80	100	80	120	M6	3	9	71/63	90/100	165	130	200	11.5	3.5	10	71/63	-
90	115	95	140	M8	3	9	80/71	100/112	165	130	200	11.5	3.5	12	71*	-
100	130	110	160	M8	3.5	10	90	132	215	180	250	14	4	14	90/80/71*	-
112	130	110	160	M8	3.5	10	90	132	215	180	250	14	4	14	90*/**	-
132	165	130	200	M10	3.5	30	112/100	-	265	230	300	14	4	14	112*	-
160	215	180	250	M12	4	12	132***	-	300	250	350	18	5	15	132***	-

* May require windings pressed at additional cost
 ** Shaft machining required at additional cost
 *** If frame is 160L: shaft extension is required.
 If frame is 160M: shaft extension and bearing repositioning is required